

REVISIONS				
ZONE	REV.	DESCRIPTION	DATE	APPROVED

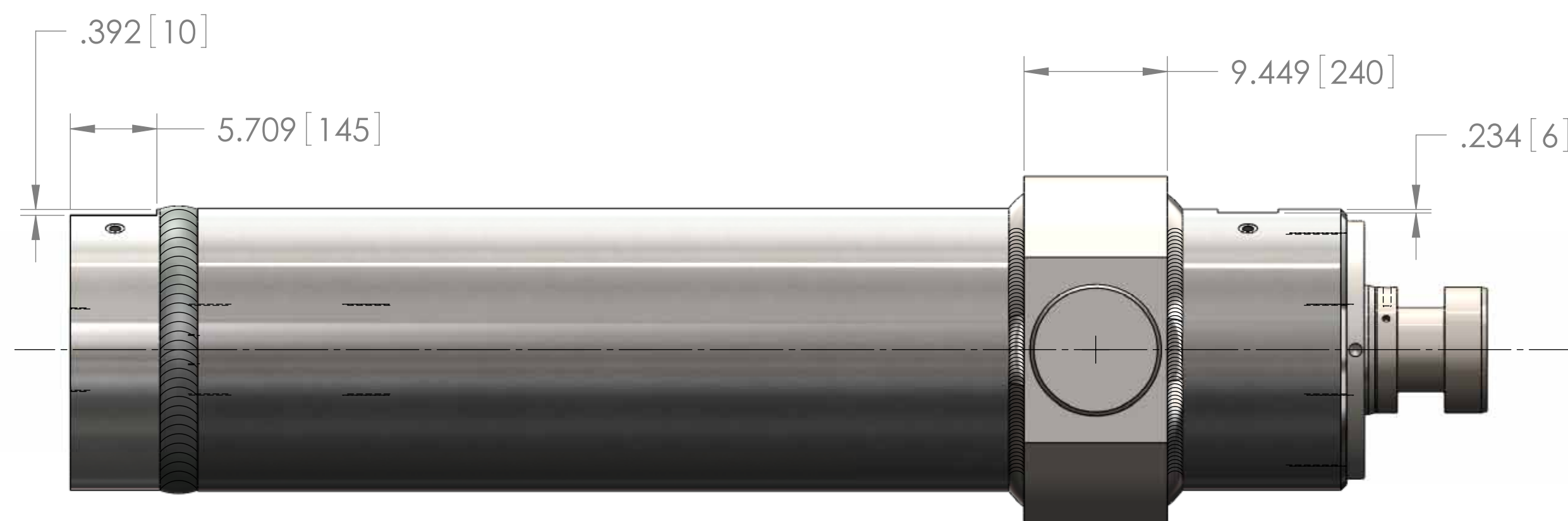
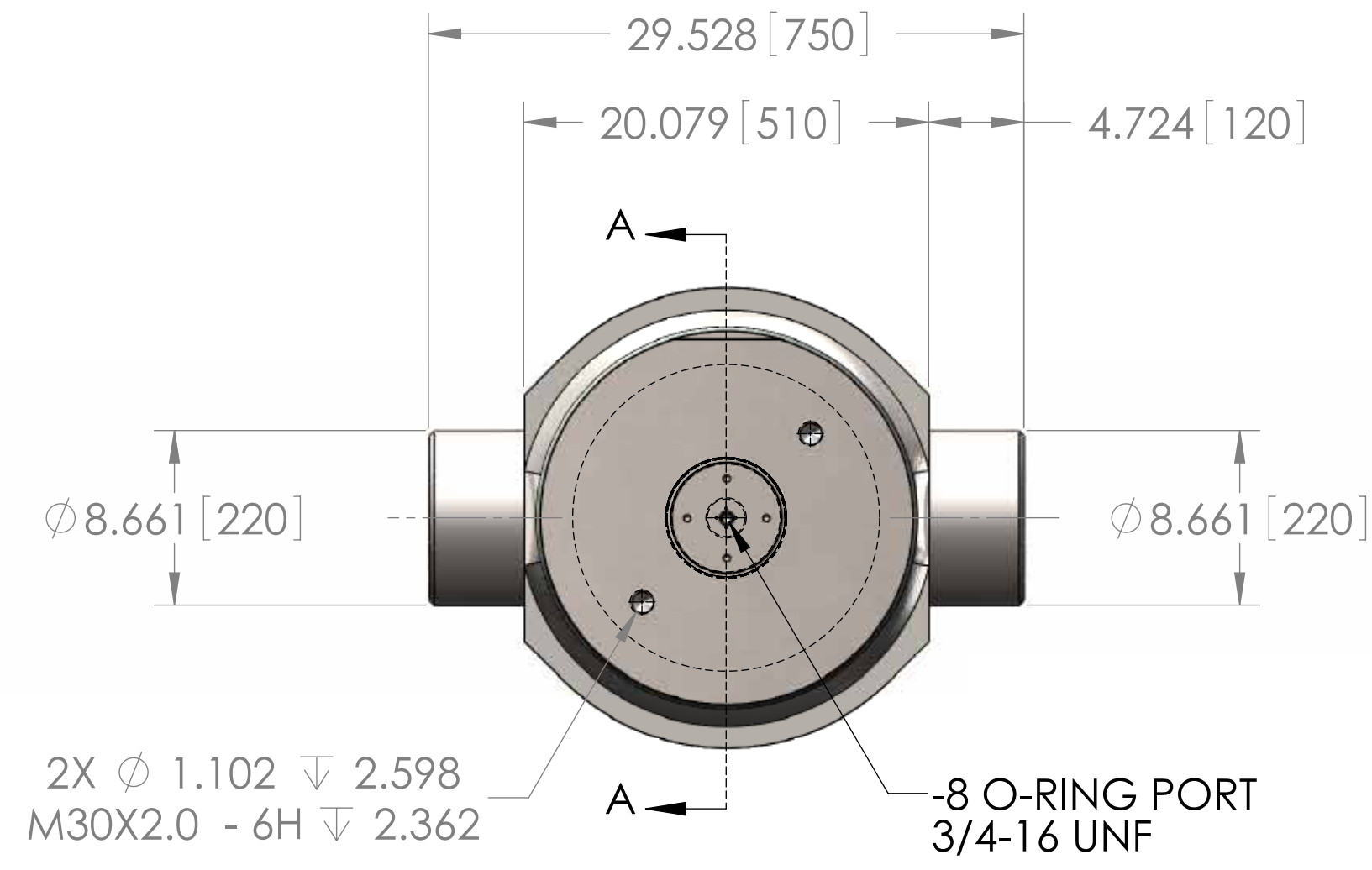
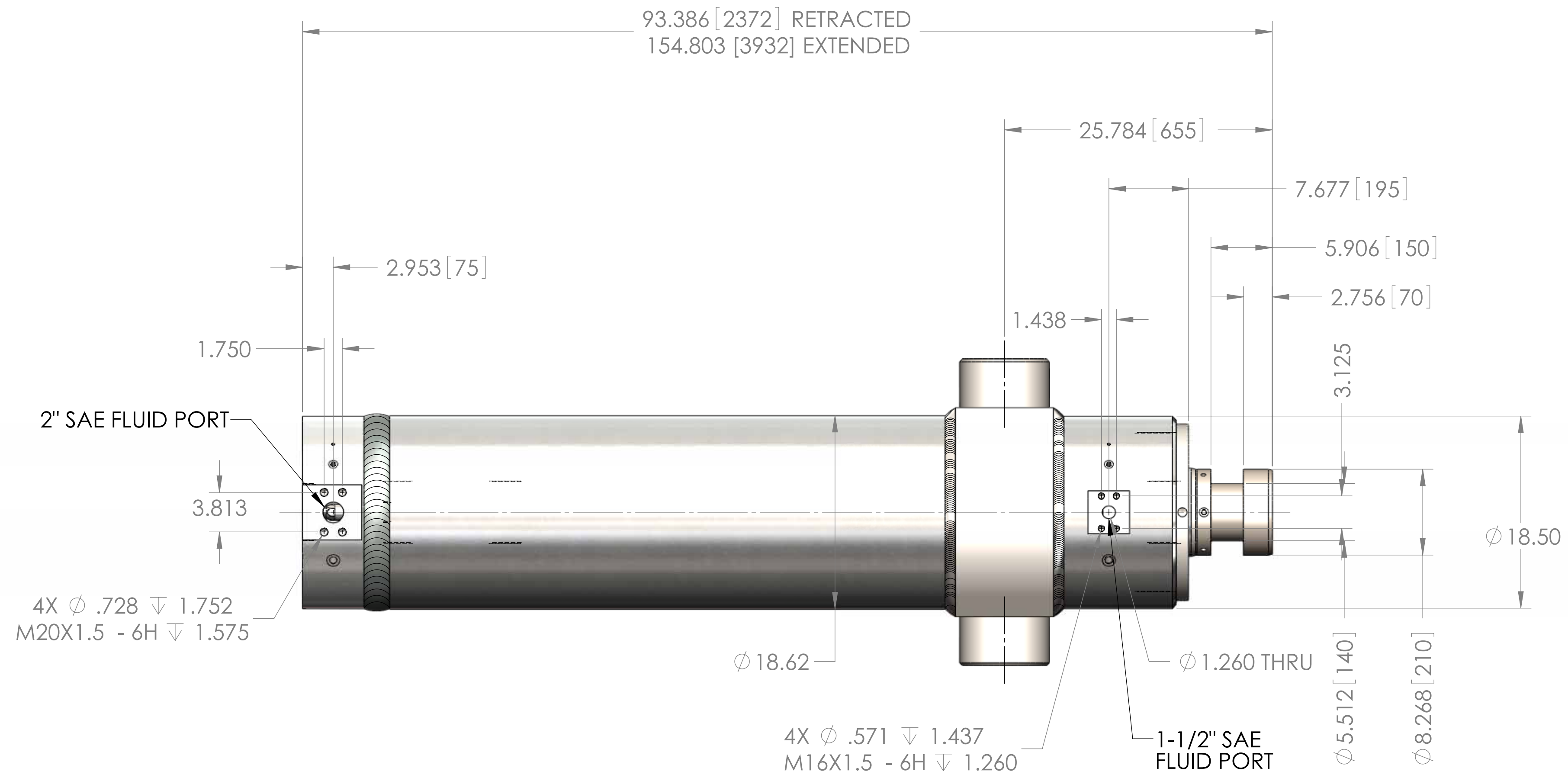

CYLINDER OUTLINE

2. CYLINDER TO ACCEPT TEMPO-SONIC POSITIONING TRANSDUCER PN# TTS-RB-U-0630-DE-004.

1. CYLINDER SPECIFICATIONS:
- BORE DIA. = Ø 14.500
 - ROD DIA. = Ø 8.500 CHROME PLATED
 - STROKE = 61.417 [1560]MM
 - WORKING PRESSURE = 320 BAR
 - TESTING PRESSURE = 410 BAR

- 5. MIN. CYLINDER BARREL YIELD STRENGTH TO BE 60KPSI.
- 4. DESIGN SAFETY FACTOR = 2.5
- 3. REFERENCE: SMS DRAWING 921844119.

NOTES: UNLESS OTHERWISE SPECIFIED.

PROPRIETARY AND CONFIDENTIAL
THE INFORMATION CONTAINED IN THIS DRAWING IS THE SOLE PROPERTY OF PRECISION EQUIPMENT INC. ANY REPRODUCTION IN PART OR AS A WHOLE WITHOUT THE WRITTEN PERMISSION OF PRECISION EQUIPMENT INC. IS PROHIBITED.

UNLESS OTHERWISE SPECIFIED:		NAME	DATE	PRECISION EQUIPMENT INC. PORTLAND, OR TITLE: HYDRAULIC CYLINDER - R180 AXIAL DRIVE SIZE DWG. NO. 1 2561 REV 1 SCALE: 1:8 WEIGHT: SHEET 1 OF 9
DIMENSIONS ARE IN INCHES		M. OKEL	06/03/10	
TOLERANCES:				
FRACTIONAL: 1/32 ANGULAR: MACH ± BEND ± TWO PLACE DECIMAL ±.010 THREE PLACE DECIMAL ±.005				
INTERPRET GEOMETRIC TOLERANCING PER: ANSI Y14.5		COMMENTS:		
MATERIAL				
NEXT ASSY	USED ON	FINISH	125/	
APPLICATION				